

This drawing has been created automatically according to your specification. It is an exemplary, legally non-binding information only.

Ansicht Z Masstab (view) (scale) 2:1

Schnitt A-A um 90 Grad gedreht (section A-A turned by 90 degrees)

Groesste Fahrerhaushoeh beim Kippen, unbeladen. (max. height over cab when tilted, vehicle unladen)

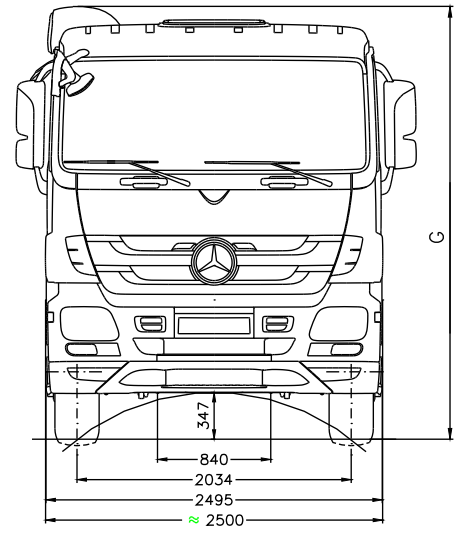
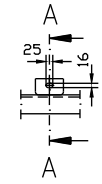
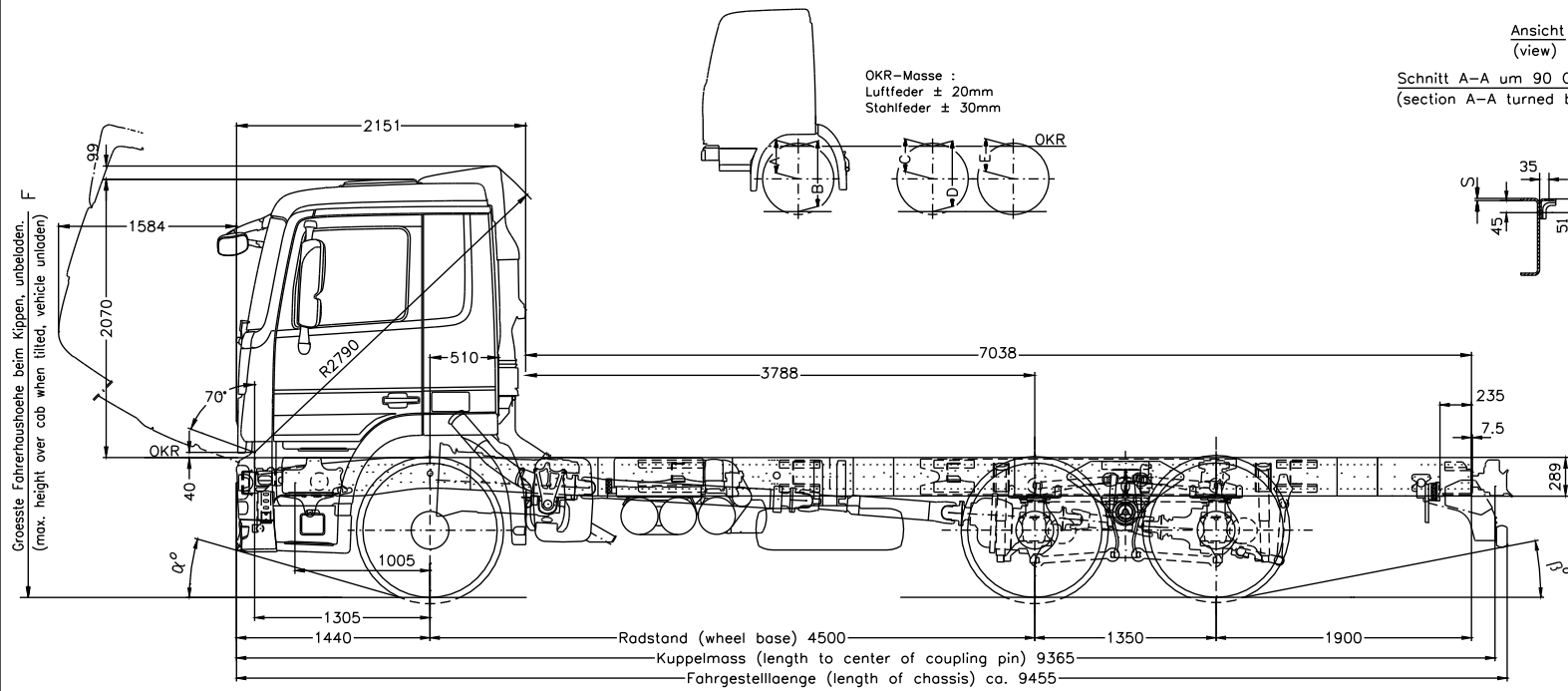

Masse Mitte Aufbaukonsole (Sonderausfuhrung Code CR4) (dimensions to center of body support bracket) (option code CR4)

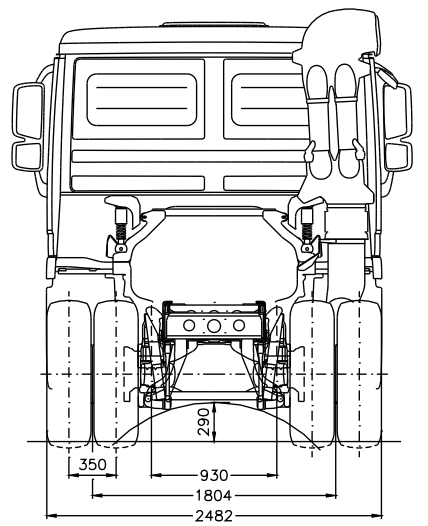
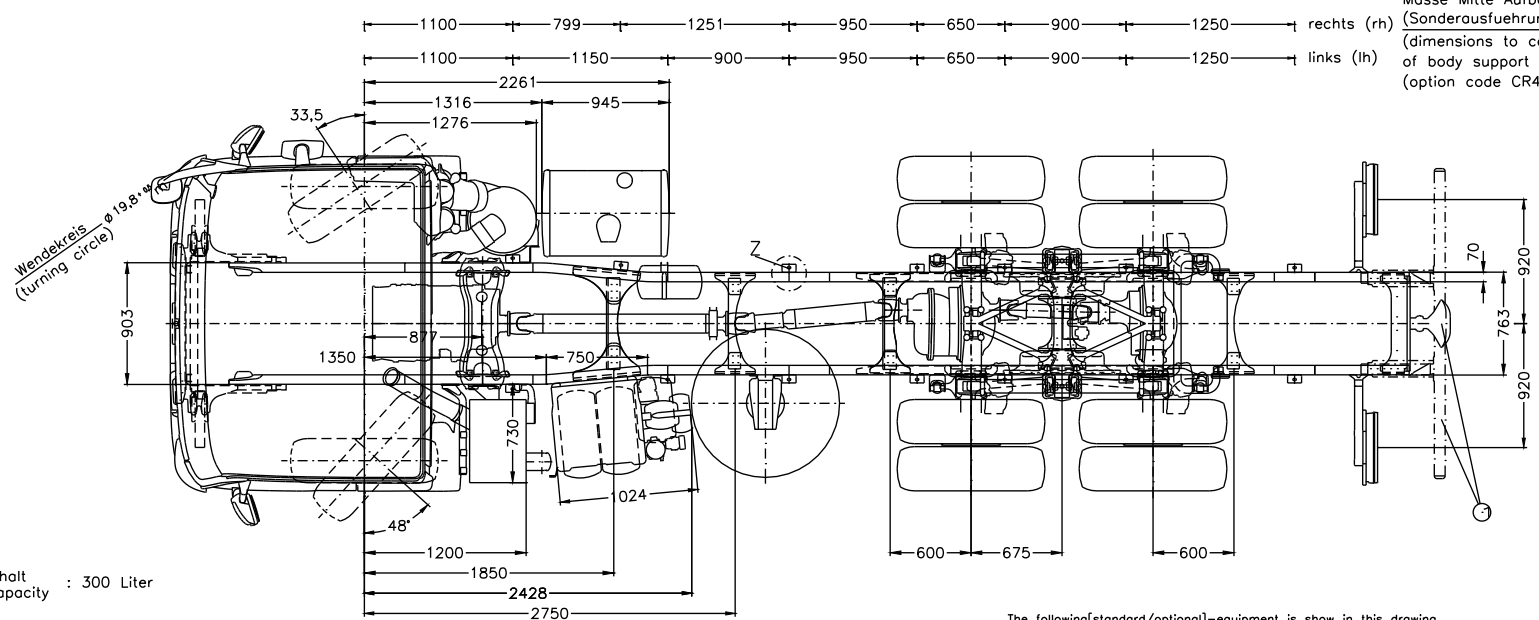

Inhalt Capacity : 300 Liter

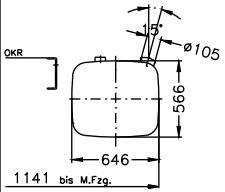

Attention : Please check the drawing for compliance with your order specification. Codes not listed here, CTT codes and non-standard tyres are not shown in this drawing.

① Ausstattung siehe Verkaufstaschenbuch (equipment see sales documentation)

- The following [standard/optional]-equipment is shown in this drawing
- Spare wheel : Spare wheel winch on side of chassis - R70
- Cab/Engine air intake : Medium cab, Cyclone pre-cleaner - M67
- Exhaust : Exhaust silencer outlet downward to side - KH8
- Fuel tank : Main tank 300 litres, steel - KS2
- Suspension : Steel
- Frame overhang : 1900 mm

| Baumuster : (vehicle type) 930,163-12     | Rahmenlaengstroeger (frame side member) Material (material) E500TW   | A II            |                     | B II            |                     | M II            |                     | N II            |                     | C II            |                     | D II            |                     | E               |                     | F               |                     | G II            |                     | D <sup>0</sup>  |                     | beta <sup>0</sup> |                     | gamma <sup>0</sup> |                     | Alle Massangaben beziehen sich auf die serienmassige Ausfuhrung. (all dimensions refer to the standard version.)<br>Fahrzeug belastet mit Wasser. (Measurements of laden vehicle.)<br>zur Projektierung von Fremdanbauelementen ist unsere Autorisation zu beachten. (for instructions for the manufacture of superstructures must be observed, when planning to fit bodies of other than Mercedes-Benz manufacture.)<br>Konstruktionsaenderungen vorbehalten. (Subject to change.) | Fuer diese Zeichnung behalten wir uns alle Rechte vor. Sie darf weder reproduziert noch Dritten gegenpaendlich gemacht werden. (We reserve all rights for this drawing. The drawing may neither be copied nor passed on to any third person.) |
|---|--|-----------------|---------------------|-----------------|---------------------|-----------------|---------------------|-----------------|---------------------|-----------------|---------------------|-----------------|---------------------|-----------------|---------------------|-----------------|---------------------|-----------------|---------------------|-----------------|---------------------|-------------------|---------------------|--------------------|---------------------|---|---|
|   |  | beladen (laden) | unbeladen (unladen) | beladen (laden) | unbeladen (unladen) | beladen (laden) | unbeladen (unladen) | beladen (laden) | unbeladen (unladen) | beladen (laden) | unbeladen (unladen) | beladen (laden) | unbeladen (unladen) | beladen (laden) | unbeladen (unladen) | beladen (laden) | unbeladen (unladen) | beladen (laden) | unbeladen (unladen) | beladen (laden) | unbeladen (unladen) | beladen (laden)   | unbeladen (unladen) | beladen (laden)    | unbeladen (unladen) |   |   |
| 9900100                                   | S=Materialdicke (S=material thickness) 9.5<br>Max.Federweg/ Hoeherverstellung (possible height adjustment) | 1041            | 1133                | -               | -                   | -               | -                   | -               | -                   | 540             | 406                 | 361             | 1040                | 1130            | 540                 | = 3963          | = 3302              | 16              | 11                  | -               | -                   | -                 | -                   | -                  | -                   | zul.Gewicht (gross vehicle weight)<br>Gewichtsvariante TOR6 33.0 t (7.5/13.0/13.0)<br>Weight variant TOR6 33.0 t (7.5/13.0/13.0)  | Fahrgestell (chassis) mit mittellaengerem Fahrerhaus (with compact (medium) sleeper cab) 3332/6x4/45  |
| Bereifung (tyres) 315/80R22.5 R stat. 500 |  |                 |                     |                 |                     |                 |                     |                 |                     |                 |                     |                 |                     |                 |                     |                 |                     |                 |                     |                 |                     |                   |                     |                    |                     | Mercedes-Benz   | HVA 0301200   |

Homologationsbeleg des aufgetragenen Fahrzeuges ist durch den ABH sicherzustellen. (It is the bodybuilder's responsibility to make sure that the completed vehicle meets the requirements for homologation.)

Formal Data Table:

|         |             |             |             |
|---------|-------------|-------------|-------------|
| 9900100 | 3332/6x4/45 | 3332/6x4/45 | 3332/6x4/45 |
|---------|-------------|-------------|-------------|

Mercedes-Benz